

## Basis of Adjacent Ways Cost – Pima Elementary Rebuild

Total

\$645,691

We have included this cost to cover the Bus and Fire equipment access lanes throughout the site as well as the offsite improvements in the public way adjacent to school property, highlighted below as directed by Hunt & Caraway Architects and Scottsdale USD. The scopes of work that fall within these boundaries are as follows: Survey & Staking, Earthwork & Paving, Offsite Utility connections, Material Testing & Special Inspections, Signage & Striping, Fire Department Access Gates, Curbing adjacent to fire lanes and Site Concrete paving for fire lanes. CORE is not the defining authority for the scope of work classified as Adjacent Ways.

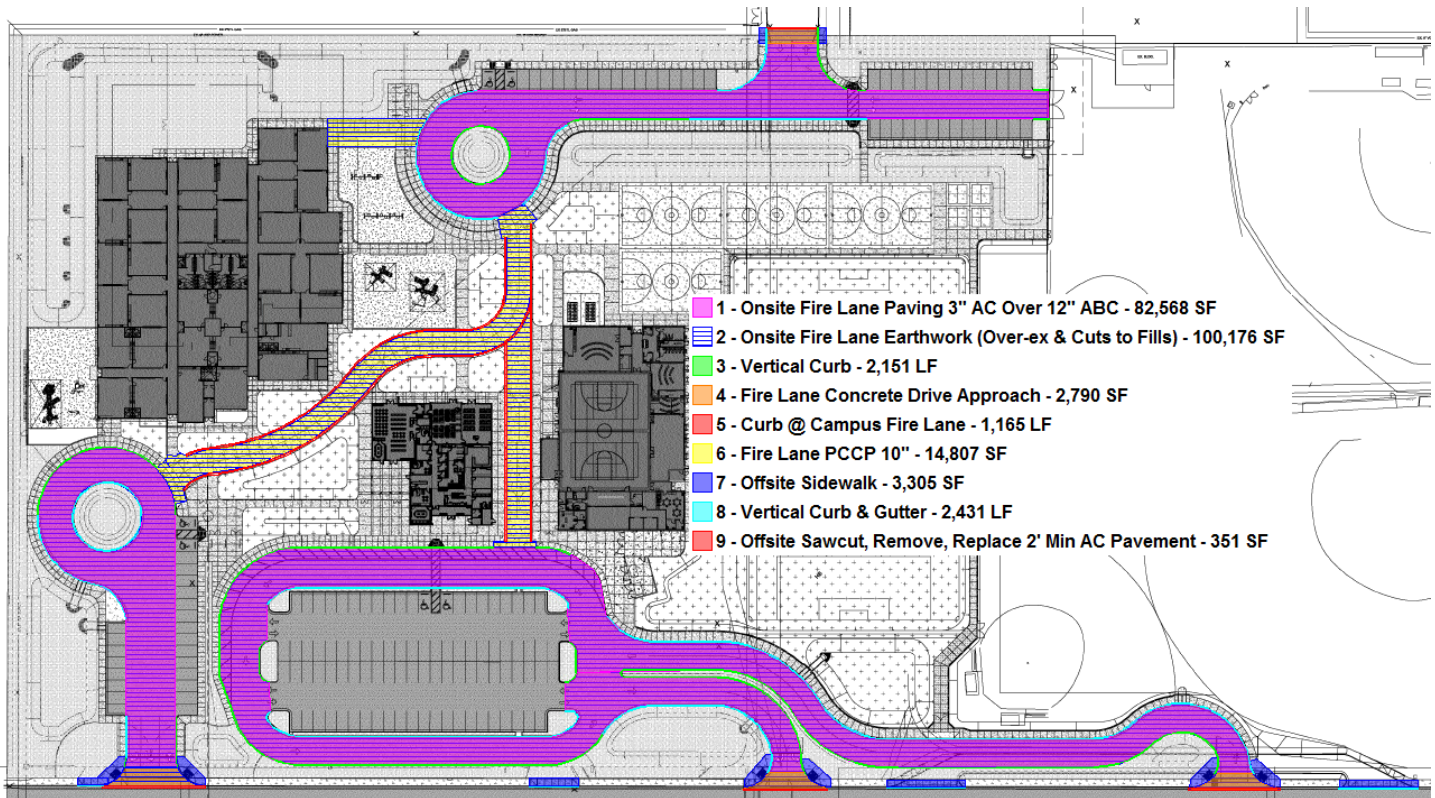

**Utility Connections:**

Fire Line Connection @ E. Osborn Road

